

### Form ORBITER:

### Attach ORBITER to TANK/ROCKET:

- 3** Turn orbiter body and wing pieces over, printed surface down. Fold wing nose flap (A and B) down. Fold body nose flaps up and insert AA into slot A, and tab BB into slot B. Fold up hooked tabs C and D on the wing piece.



- 4** Turn orbiter, printed surfaces up. Fold down body side panels and insert tabs E, F, G, and H into slots I, J, G, and H in the wing piece. Slide tail piece in slot at back end of orbiter body.



- 5** Insert orbiter hook tabs C and D into tank front holes C and D.



Lay Air Racer BODY flat and printed side down.

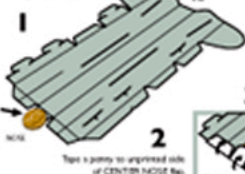

Fold up sides of Air Racer BODY.

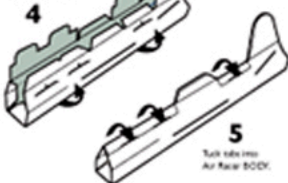

2 Tape a joint to unprinted side of CENTER NOSE flap.

5 Tuck tabs into Air Racer BODY.

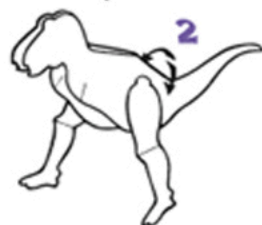

**T-REX**

## Windchaser

MIDGET AIR RACER



Push LARGE WING through LARGE slots in Air Racer BODY. Push SMALL WING through SMALL slots.



Hold WING TABS up against Racer BODY to keep WING(s) centered.